

SQUARE LO

303RA01L11

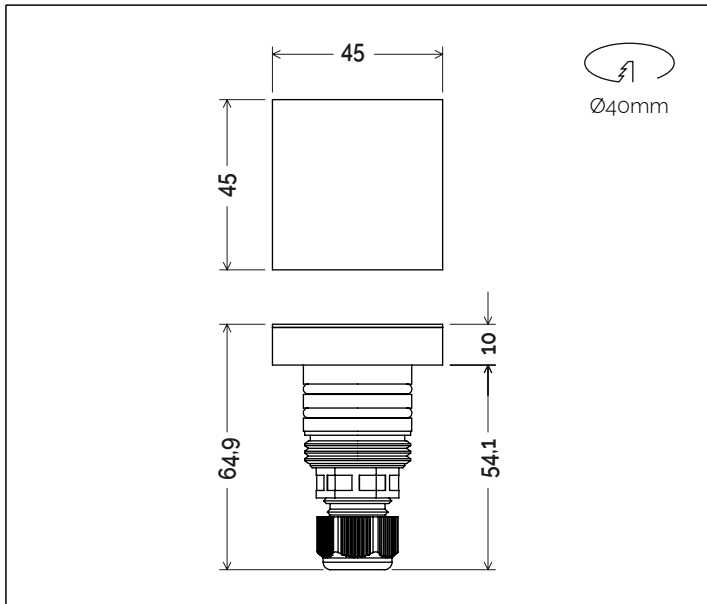
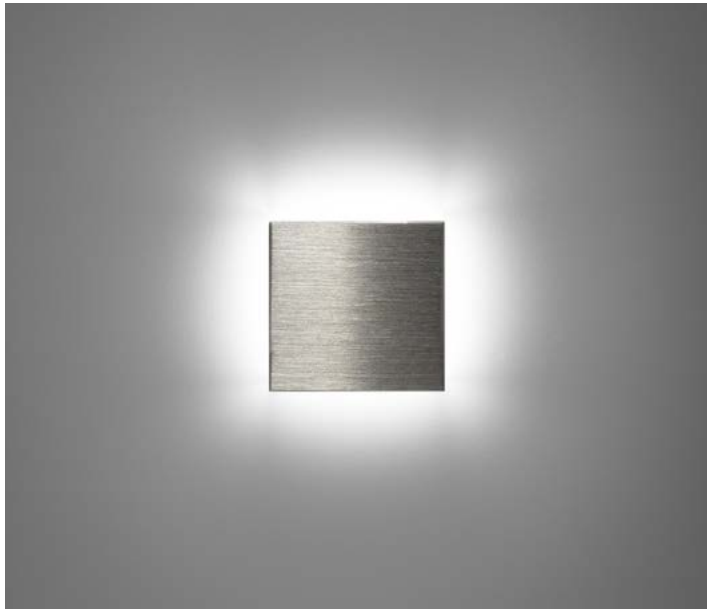

Descrizione del prodotto / Product description

Segnapasso LED da incasso con ottica ad emissione radiale per interno ed esterno. Lente in PMMA trasparente vibrolucidato con schermo frontale in Acciaio Inox Satinato o Verniciato. Guarnizioni OR in gomma siliconica (eccellente resistenza all'ozono, all'esposizione agli agenti atmosferici e all'invecchiamento). Pressacavo posteriore IP68. Power LED di potenza ad altissima efficienza CRI ≥90. Cavo di collegamento in neoprene, fornito con sistema di connessione rapida termoretraibile. (vedi istruzioni di montaggio).

Built-in swivel wall footlights radial emitting, for indoor/outdoor applications. Clear PMMA optic with upper protection screen made of Satin or painted Stainless Steel. O-rings made of silicon rubber (excellent resistance to ozone, exposure to atmospheric agents and aging). Rear cable gland P68. Power LED with very high efficiency CRI ≥90. Neoprene cable connection, supplied with heat shrink fast connection system. (see assembly instructions)

Dati tecnici | Technical Info

* su richiesta / on requests

Finiture Finishes	● 4003 Grafite Graphite
	● 4004 Cemento Concrete
	● 4006 Corten Scuro Dark Corten
	● 4011 Bronzo Bronze
	○ 4015 Bianco Fiorentino Florentine White
	● 4024 Rosso Bolgheri Bolgheri Red
	● Verniciati RAL RAL Paintings*
Potenza Power	12W
Corrente Current	-
Tensione Voltage	24Vdc
Tolleranza cromatica Chromatic tolerance	3 SDCM
Flusso luminoso Luminous Flux	126 lm
Mantenimento del flusso luminoso Flux Maintenance	≥50.000h
Temperature di esercizio Operating temperature	-20° ~ 45°

Simbologia tecnica Technical informations

	Conforme alle direttive CE
	Conforme alle normative RoHs
	Classe III
IP65	Indice di Protezione IP65
	Connettore stagno in dotazione

Temperatura di Colore Color Temperature

9027 - 2700K CRI 92
9030 - 3000K CRI 92
9040 - 4000K CRI 92

Ottiche Optics

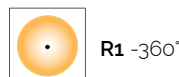

Sistemi di Controllo Control System

	On / Off (remoto escluso / remote excluded)
PUSH	Push * (remoto escluso / remote excluded)
1-10V	1-10V, 0-10V * (remoto escluso / remote excluded)
	DALI * (remoto escluso / remote excluded)

Creazione Codice | Code construction

303RA01L11-XXXX-XX-XXXX

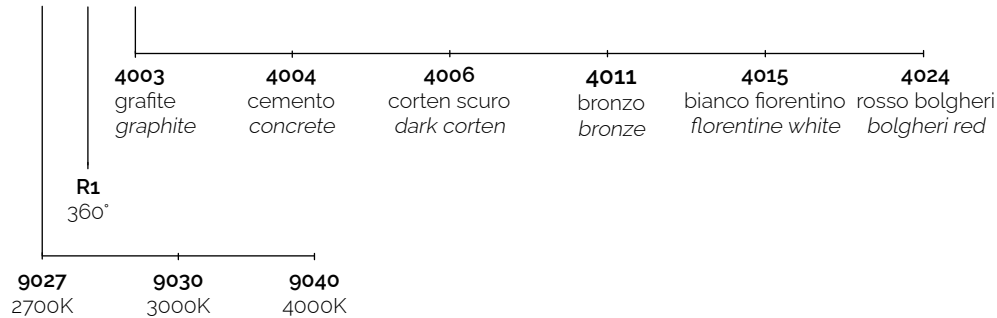

Dati Fotometrici | Photometric Specification

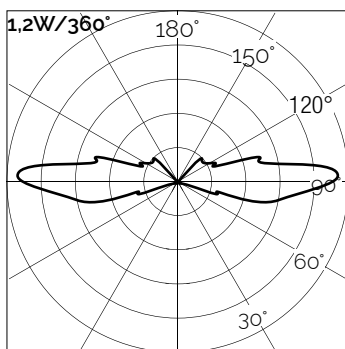

R (m)	E (lx)
0.05	1690
0.10	570
0.20	140
0.50	20
1.00	6

Accessori | Accessories

9F005

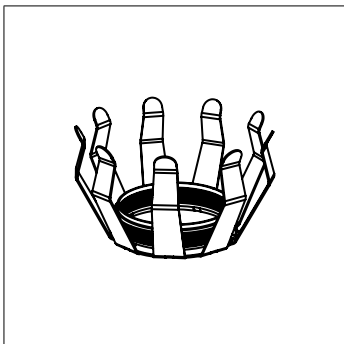

Molla di fissaggio.
(foro su pannello Ø40mm)

Fixing Spring.
(hole on panel Ø40mm)

9A005

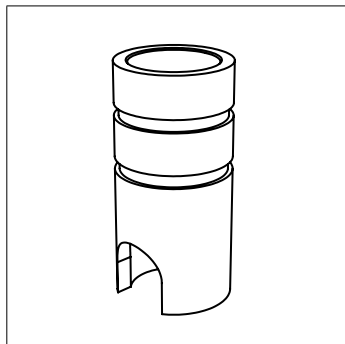

Cassaforma per incasso
(Ø38mm H.75mm)

Recessed Box
(Ø38mm H.75mm)

Alimentatori | *Led*

Tipo Alim. / Driver Type	potenza / power	tensione / voltage	dimensioni / dimensions	n. prodotti	IP	codice / code
ON/OFF	10W	24Vdc	39x22x75mm	1 ~ 8	20	9M301
	14W	24Vdc	38x25x79mm	1 ~ 10	67	9M401
DALI	60W	24Vdc	35x53x150mm	1 ~ 15	67	9M805